



# HTC series

Front end telescopic cylinder  
2500 PSI WP

MODEL	STROKE	A	B	C	D	E	F	G	H	L	kg
7 TONS											
HTC-07833	78"	35.5"	3.75"	2"	1.063"	2.5"	1.25"	6.5"	1.25"	7"	37
HTC-09033	90"	39.5"	3.75"	2"	1.063"	3.0"	1.25"	6.5"	1.25"	7"	41
HTC-10833	108"	45"	3.75"	2"	1.063"	3.0"	1.25"	6.5"	1.25"	7"	46
12 TONS											
HTC-07843	78"	34.75"	4.4"	2"	1.063"	2.25"	1.5"	7.5"	1.5"	7"	48
HTC-09043	90"	38.75"	4.4"	2"	1.063"	2.25"	1.5"	7.5"	1.5"	7"	52
HTC-10843	108"	44.75"	4.4"	2"	1.063"	2.25"	1.5"	7.5"	1.5"	7"	59
HTC-12043	120"	48.75"	4.4"	2"	1.063"	2.25"	1.5"	7.5"	1.5"	7"	64
HTC-14443	144"	56.78"	4.4"	2"	1.063"	2.25"	1.5"	7.5"	1.5"	7"	74



Actual cylinder color is BLACK

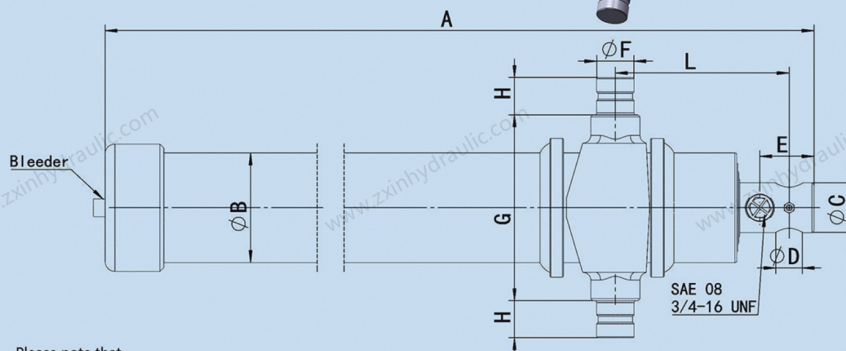

Please note that

- Cylinder is a lifting device only and not a structural member. • Cylinder should not work at overload, side load conditions.
- The working pressure is up to actual service condition, don't over the Max pressure.